

Fixture Type:

Job Name:

# Series M60, M62, M64

*Floating Clouds of Light, Fluorescent Surface Modules*



## DESCRIPTION:

A floating cloud of brilliant light illuminates softly and efficiently while making a bold statement. Gives a room the general overall lighting needed for doing tasks properly and safely. Whether used as a single unit in a residential kitchen or used in multiples in a commercial or retail space, the illuminated cloud distributes soft, uniform illumination with high visual comfort and superior brightness control. Broad angle illumination lights the walls and vertical surfaces from floor to ceiling creating a more open and comfortable space. A component of light above 90 degrees lights the ceiling. The floating cloud diffuser envelops the fixture chassis, either blacked out for a contrasting floating effect or white for a clean disappearing effect. Modules are available in 1X2, 1X4, 2X2, and 2X4 sizes. On request, 3X3 and 4X4 sizes may be available. Choose linear fluorescent T8 or T12 lampping for all module sizes or compact fluorescent TT5 lampping for the 1X2 and 2X2 sizes.

## DIFFUSER:

The soft matte white cloud diffuser is fabricated from virgin acrylic plastic with a DR component formulated in to add strength and breakage resistance. A nominal 1/8" thickness offers total lamp obscurity while still allowing maximum light transmission. The diffuser glows evenly without lamp imaging. Four metal hinging clips allow for a positive lift and shift fit to the chassis.

## CONSTRUCTION:

The housing is die formed from heavy gauge code grade cold rolled steel with spot welded ends for strength and rigidity. A snap-in type internal wiring cover is provided for easy ballast access. Ample knockouts on the housing back allow for mounting and electrical feeds. All steel parts are finished in baked white enamel applied after a multi-stage cleansing and phosphate coating. Will provide a minimum reflectivity of 87%. Blacked out housings have a matte black enamel additionally applied to the outer surfaces.

## ELECTRICAL:

Ballasts are standard as T8 electronic or T12 magnetic. Selected T12 electronic ballasts are optional where available. Electronic ballasts are high power factor, normal light output, and have harmonics of less than 20% THD. Special ballast performances should be specified. A multiple lamp ballast operating 3- or 4-lamps where available is standard unless specified with two ballasts. Magnetic T12 ballasts are high power factor, energy saving type. Ballasts for 20W-T12 lamps are low power factor, unless specified HPE. Other optional ballasts include dimming types, emergency battery packs, and commercially available products as specified. Standard voltages are 120V-60HZ and 277V-60HZ or as specified. UL listed 1598 with CUL approval and bears their label. Union made and labeled.

## MOUNTING:

Fixtures are designed for individual ceiling mounting only. Suitable for direct surface mounting or suspended on stems, cable, or rods.



Fixture Type:

Job Name:

Series	No. of Lamps Cross	Lamp Wattage/Ea. Nominal Fix. Length	Optional Housing Finish	Lamp Type	Ballast Type	Voltage	Misc.
<b>M60</b> 1X2	<b>-1</b> Lamp 1X2, U6-Lamp Only	<b>-17</b> 17W-T8-2Ft.	- Blank: Black Housing	<b>-OCT</b> Octron T8 17W & 32W Only	<b>-ELB</b> Electronic T8, T12	<b>-120V</b> 120 Volt-60HZ	<b>-EMPK</b> Emergency Pack I-24, B-100
<b>M60</b> 1X4	<b>-2</b> Lamps	<b>-20</b> 20W-T12-2Ft.	<b>-WHT</b> White Housing	<b>-OCT-U</b> Octron T8 U-Lamp/1-5/8"	<b>-ELB-HP</b> Electronic T8, <10% THD	<b>-277V</b> 277 Volt-60HZ	<b>-EMPKS</b> Emergency Pack I-80, B-50
<b>M62</b> 2X4	<b>-3</b> Lamps 2X2, 2X4 Only	<b>-32</b> 32W-T8-4Ft. 31/32W-T8-U-2Ft.		<b>-OCT-U6</b> Octron T8 U-Lamp/6"	<b>-ELBL</b> Electronic T8, Low Watt	<b>-UNI</b> Universal Voltage 120V-277V 50HZ-60HZ T8 Only	<b>-2B</b> 2-Ballasts 2-Circuit/Switching
<b>M64</b> 2X2	<b>-4</b> Lamps	<b>-40</b> 34/40W-T12-4Ft. 34/40W-T12-U6-2Ft. 40W-TT5-2Ft.		<b>-BIAx</b> Compact TT5 40W Only	<b>-ELBH</b> Electronic T8, High Light Output	- Other Voltages	- As Specified
		- As Specified		<b>-Q</b> Trigger Start T12 20W Only	<b>-ESB</b> Magnetic T12, Energy Saving Ballast, 40W		
				<b>-RS</b> Rapid Start T12 40W Only	- Blank: Magnetic T12 LPF 20W Only		
				<b>-RS-U</b> Rapid Start T12 U-Lamp/6" 40W Only	- As Specified		

**Dimensional Data**

**Cross Section / Cut-Away**

1 Ft. Wide

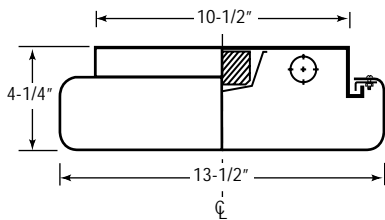

2 Ft. Wide

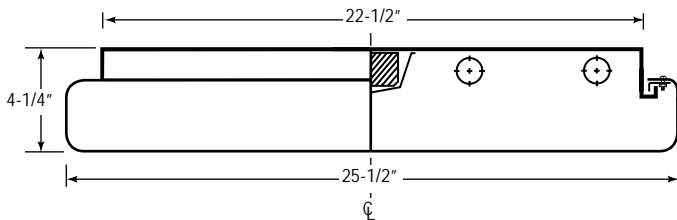

**Diffuser Overall Lengths**

- 1 X 2 = 26"      1 X 4 = 50"
- 2 X 2 = 26"      2 X 4 = 50"

**Plastic Mounting & Hinging Detail**

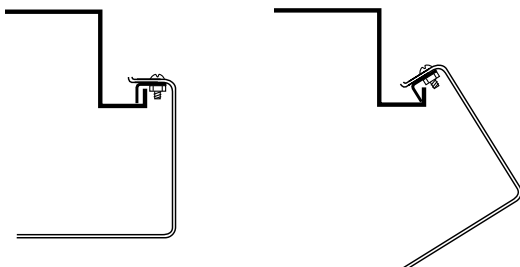

**Back Plans**

⊕ = 7/8" KO  
⊙ = 2" KO

2X2

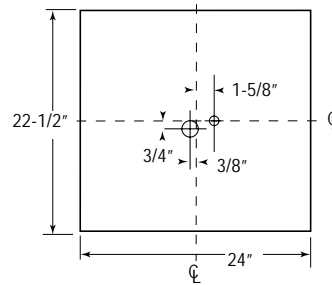

1X4

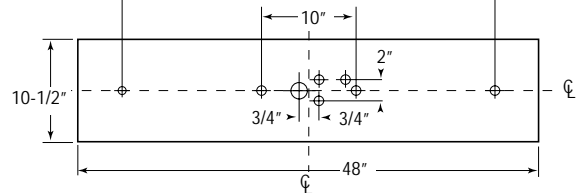

2X4

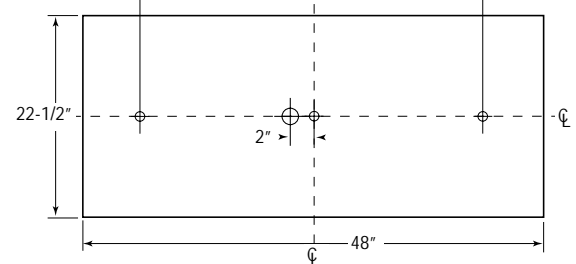

20 AUDREY PLACE, FAIRFIELD, NEW JERSEY 07004 □ 973-244-9444 □ FAX 973-244-9522