



LTL NUMBER: 05151 DATE: 4-21-2000
PREPARED FOR: MERCURY LIGHTING PRODUCTS COMPANY INC.
CATALOG NUMBER: Q6-F2-28-T5-W-ELB-120V
LUMINAIRE: FORMED STEEL HOUSING, FORMED WHITE ENAMEL STEEL REFLECTOR, OPEN TOP.
LAMPS: TWO PHILIPS TL5 28W/830HE RATED AT 2900 LUMENS EACH.
BALLAST: ONE SYLVANIA QT2X28/120PS
MOUNTING: PENDENT

LUMEN TO CANDELA RATIO USED = 9.18
TOTAL INPUT WATTS = 64.0 AT 120.0 VOLTS
THE 0 DEGREE PLANE IS PARALLEL WITH THE LAMPS.

#05151

Table with columns: CANDELA DISTRIBUTION (0.0, 22.5, 45.0, 67.5, 90.0) and FLUX (209, 594, 759, 821, 785, 681, 525, 331, 113)

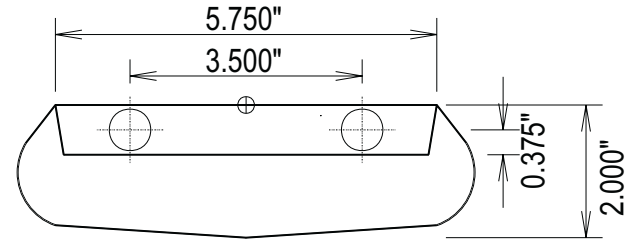

ZONAL LUMEN SUMMARY table with columns: ZONE, LUMENS, %LAMP, %FIXT

TOTAL LUMINAIRE EFFICIENCY: 83.1%
TOTAL REFLECTANCE OF PAINT: 87.3%
CIE TYPE: INDIRECT

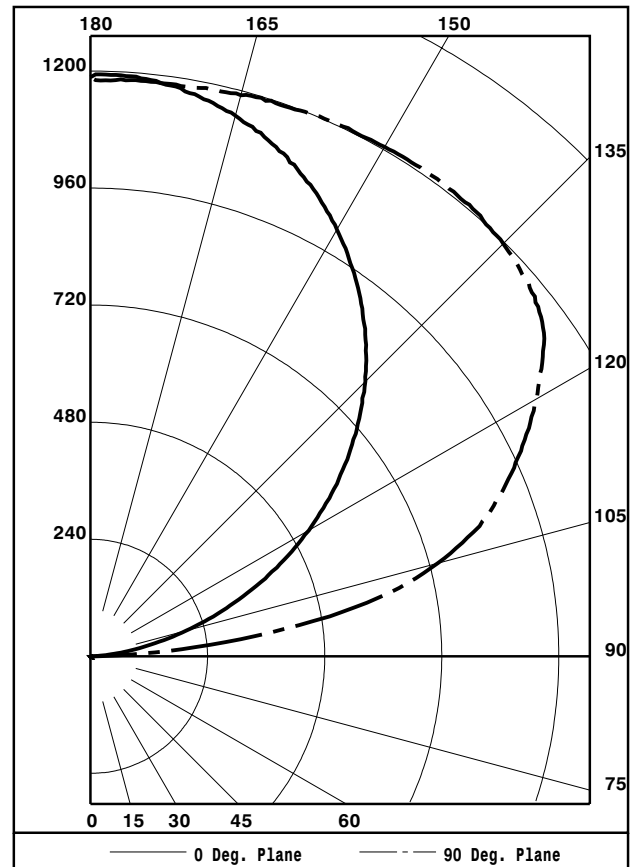

TESTED BY HERSCHEL SCHRECK
CHECKED BY MIKE GRATHER



LTL NUMBER: 05151

DATE: 4-21-2000

PREPARED FOR: MERCURY LIGHTING PRODUCTS COMPANY INC.

COEFFICIENTS OF UTILIZATION - ZONAL CAVITY METHOD
EFFECTIVE FLOOR CAVITY REFLECTANCE 0.20

Table with columns RC, RW, and rows for heights 0-10 and room widths 70, 50, 30, 10. Values represent utilization coefficients.

CANDELA DISTRIBUTION

Table showing candela values for various beam angles from 90 to 180 degrees across different beam diameters.

ZONAL LUMEN SUMMARY

Table showing zonal lumen values for various beam diameters from 90 to 180 degrees.

THIS TEST WAS CONDUCTED USING RELATIVE PHOTOMETRY TECHNIQUES ACCORDING TO STANDARD IESNA PROCEDURES. THE USER MUST THEREFORE USE CAUTION IN THE FOLLOWING SITUATIONS: 1) THIS TEST WAS PERFORMED USING A SPECIFIC BALLAST/LAMP COMBINATION. EXTRAPOLATION OF THESE DATA FOR OTHER BALLAST/LAMP COMBINATIONS MAY PRODUCE ERRONEOUS RESULTS. 2) ACCORDING TO IESNA PROCEDURES, THE BALLAST(S) AND LAMP(S) ARE PRESUMED TO PRODUCE 100% OF RATED OUTPUT. AN APPROPRIATE BALLAST FACTOR MUST BE APPLIED TO THE LUMEN OUTPUT RATINGS AND LUMINOUS INTENSITY VALUES GIVEN. 3) THIS TEST WAS CONDUCTED IN A CONTROLLED LABORATORY ENVIRONMENT WHERE THE AMBIENT TEMPERATURE WAS HELD AT 25°C ±1°C. FIELD PERFORMANCE MAY DIFFER PARTICULARLY IN REGARDS TO CHANGE IN LUMINOUS OUTPUT AS A RESULT OF DIFFERENCE IN AMBIENT TEMPERATURE AND METHOD OF MOUNTING THE LUMINAIRE.