



LTL NUMBER: 01629

DATE: 5-24-1994

PREPARED FOR: MERCURY LIGHTING PROD.

CATALOG NUMBER: MM-259-OCT-ELB-120V/
MM-259-OCT-P-ELB-120V-20GA

LUMINAIRE: FORMED STEEL HOUSING, WHITE ENAMEL REFLECTOR, NO ENCLOSURE.
PRORATED FROM LTL TEST #01624

LAMPS: TWO GE F96T8/CW/WM RATED AT 3450 LUMENS EACH.

MOUNTING: SURFACE

LUMEN TO CANDELA RATIO USED = 9.17

TOTAL INPUT WATTS = 61.3 AT 120.0 VOLTS

THE 0 DEGREE PLANE IS PARALLEL WITH THE LAMPS.

#01629

CANDELA DISTRIBUTION						FLUX
	0.0	22.5	45.0	67.5	90.0	
0	1259	1259	1259	1259	1259	120
5	1253	1255	1260	1254	1259	351
15	1208	1219	1246	1260	1273	559
25	1119	1149	1213	1267	1296	729
35	992	1049	1173	1273	1316	843
45	830	926	1115	1253	1305	879
55	638	788	1025	1179	1235	827
65	425	644	879	1047	1115	678
75	209	449	713	855	904	412
85	39	251	415	526	566	332
90	2	140	302	420	463	283
95	0	145	355	497	550	206
105	0	101	293	432	483	128
115	0	54	225	352	400	62
125	0	10	146	261	300	17
135	0	0	67	155	189	1
145	0	0	5	55	76	0
155	0	0	0	0	2	0
165	0	0	0	0	0	0
175	0	0	0	0	0	0
180	0	0	0	0	0	0

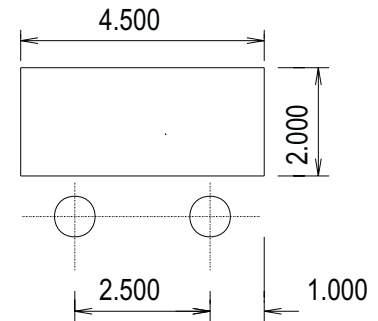

ZONAL LUMEN SUMMARY			
ZONE	LUMENS	%LAMP	%FIXT
0- 30	1031	14.9	16.0
0- 40	1760	25.5	27.4
0- 60	3481	50.5	54.2
0- 90	5399	78.2	84.0
90-120	822	11.9	12.8
90-130	950	13.8	14.8
90-150	1029	14.9	16.0
90-180	1029	14.9	16.0
0-180	6428	93.2	100.0

TOTAL LUMINAIRE EFFICIENCY: 93.2%
TOTAL REFLECTANCE OF PAINT: 89.0%
CIE TYPE: SEMI-DIRECT
PLANE: 0-DEG 90-DEG
SPACING CRITERIA: 1.3 1.6

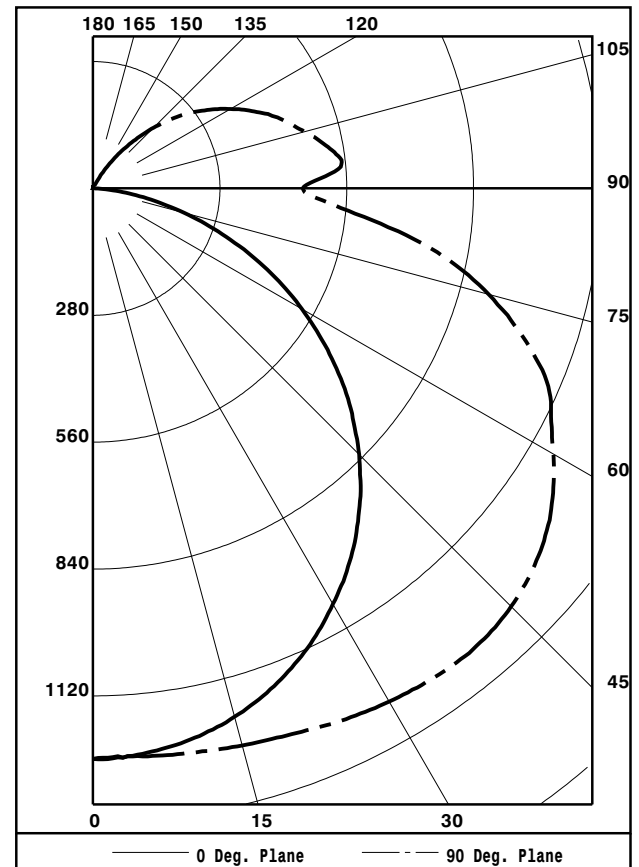

TESTED BY JOHN HAYES
CHECKED BY JAY LANGTHORN



LUMINAIRE TESTING LABORATORY, INC.



905 Harrison Street · Allentown, PA 18103 · (610) 770-1044 · Fax (610) 770-8912 · www.LuminaireTesting.com

LTL NUMBER: 01629

DATE: 5-24-1994

PREPARED FOR: MERCURY LIGHTING PROD.

COEFFICIENTS OF UTILIZATION - ZONAL CAVITY METHOD
EFFECTIVE FLOOR CAVITY REFLECTANCE 0.20

Table with 14 columns (RC, RW, 80, 70, 50, 30, 10, 0) and 11 rows (0-10) showing utilization coefficients.

PLANE: 0-DEG 90-DEG
LUMINOUS LENGTH: 96.000 4.500

LUMINANCE IN CANDELA PER SQUARE METER

Table with 4 columns (ANGLE IN DEG, AVERAGE 0-DEG, AVERAGE 45-DEG, AVERAGE 90-DEG) and 6 rows (0, 45, 55, 65, 75, 85) showing average luminance values.



LTL NUMBER: 01629

DATE: 5-24-1994

PREPARED FOR: MERCURY LIGHTING PROD.

CANDELA DISTRIBUTION

ZONAL LUMEN SUMMARY

Table with 6 columns for Candela Distribution (0.0 to 180) and 2 columns for Zonal Lumen Summary (0-5 to 175-180).

THIS TEST WAS CONDUCTED USING RELATIVE PHOTOMETRY TECHNIQUES ACCORDING TO STANDARD IESNA PROCEDURES. THE USER MUST THEREFORE USE CAUTION IN THE FOLLOWING SITUATIONS: 1) THIS TEST WAS PERFORMED USING A SPECIFIC BALLAST/LAMP COMBINATION. EXTRAPOLATION OF THESE DATA FOR OTHER BALLAST/LAMP COMBINATIONS MAY PRODUCE ERRONEOUS RESULTS. 2) ACCORDING TO IESNA PROCEDURES, THE BALLAST(S) AND LAMP(S) ARE PRESUMED TO PRODUCE 100% OF RATED OUTPUT. AN APPROPRIATE BALLAST FACTOR MUST BE APPLIED TO THE LUMEN OUTPUT RATINGS AND LUMINOUS INTENSITY VALUES GIVEN. 3) THIS TEST WAS CONDUCTED IN A CONTROLLED LABORATORY ENVIRONMENT WHERE THE AMBIENT TEMPERATURE WAS HELD AT 25°C ±1°C. FIELD PERFORMANCE MAY DIFFER PARTICULARLY IN REGARDS TO CHANGE IN LUMINOUS OUTPUT AS A RESULT OF DIFFERENCE IN AMBIENT TEMPERATURE AND METHOD OF MOUNTING THE LUMINAIRE.



LUMINAIRE TESTING LABORATORY, INC.



905 Harrison Street · Allentown, PA 18103 · (610) 770-1044 · Fax (610) 770-8912 · www.LuminaireTesting.com

LTL NUMBER: 01629

DATE: 5-24-1994

PREPARED FOR: MERCURY LIGHTING PROD.

VISUAL COMFORT PROBABILITY TABLE

RATED LUMENS PER LAMP 3450.

100. FC. ROOM		REFLECTANCES 80/50/20 LUMINAIRES 0 DEG PLANE				LUMINAIRES 90 DEG PLANE			
W	L	8.5	10.0	13.0	16.0	8.5	10.0	13.0	16.0
20	20	39	49	66	81	25	35	52	72
20	30	32	40	51	65	15	21	31	48
20	40	30	36	44	53	11	15	22	31
20	60	29	34	40	47	8	11	15	21
30	20	34	44	59	74	26	35	50	68
30	30	27	34	44	58	16	22	30	45
30	40	25	30	38	47	11	15	21	29
30	60	24	28	34	41	8	11	14	20
30	80	24	28	32	38	6	8	11	15
40	20	32	41	54	70	28	37	50	66
40	30	26	32	41	53	17	23	31	44
40	40	23	28	34	43	12	16	21	29
40	60	21	25	30	37	8	11	14	20
40	80	21	25	28	34	7	9	11	15
40	100	22	25	28	33	5	7	9	12
60	30	24	30	38	50	19	24	32	44
60	40	21	26	31	40	13	17	21	30
60	60	19	23	27	34	9	12	15	20
60	80	19	22	25	31	7	9	11	15
60	100	19	22	25	30	6	7	9	12
100	40	21	25	29	37	16	20	24	32
100	60	18	22	25	30	11	14	16	22
100	80	17	20	22	27	8	11	13	16
100	100	17	19	22	26	7	9	10	12